

1

Midland Networks Basic Health & Safety

Induction for all staff on basic health & Safety

Presented by

David Donnelly

2

Health and Safety

Health and safety is intended to bring about condition free from risk of injury or threat to our health and well-being.

This objective is not a natural state of affairs.

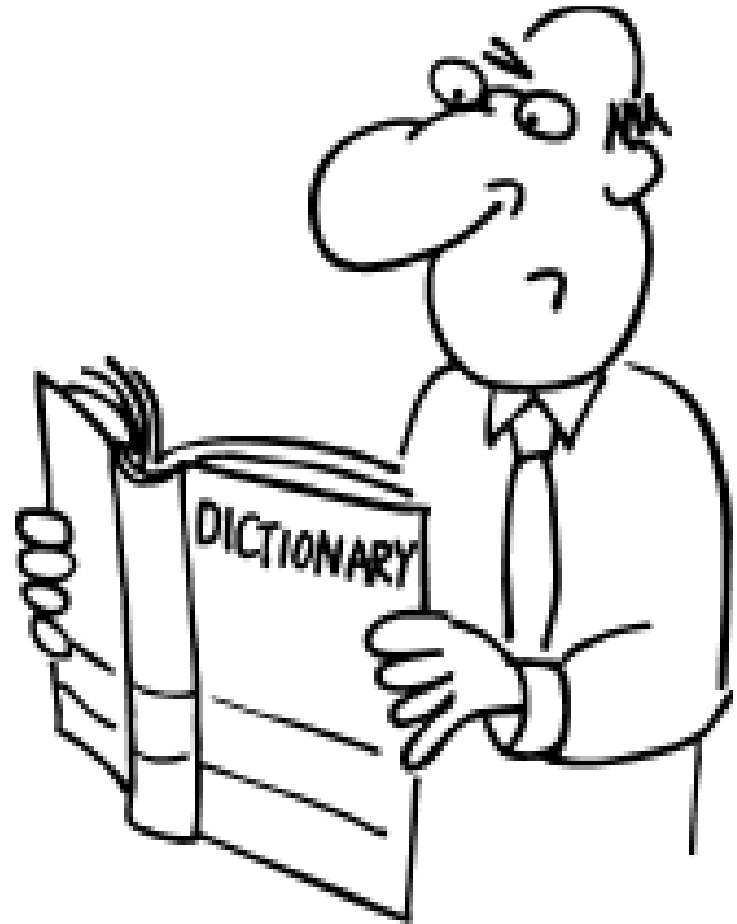

3

We Believe

Workplace accidents, illness and incidents

are preventable

provided that

**Health and Safety
is Managed**

4

Clapham Junction Accident

“A concern for safety which is sincerely held and repeatedly expressed but, nevertheless, is not carried through into action, is as much protection from danger as no concern at all.”



What could happen?

Near-miss



Minor injury



Major injury



Death

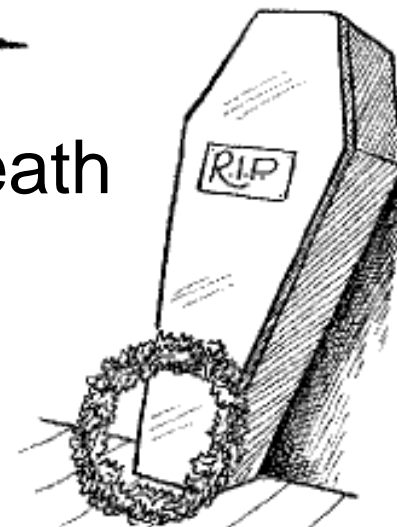

Why report accidents?

Accidents should be reported because:

- The law requires some specific types of accidents to be reported to the Enforcing Authorities.
- The Midland Networks Safety Policy requires all accidents and near misses to be reported to the USO.
- It enables investigations so as to prevent further accidents.
- Reports enable the Midland Networks to identify trends.

Report accidents on line at www.safety.net.co.uk

How big is the Accident Problem?

HSE shows accidents cost:

APAU studies

- 37% of annualised profit.
- 8.5% of tender price.
- 5% of running costs.

Bear in mind that these were large and well organised companies that already had a high standard of loss control and lower than average accident rates.



General duties on the employer

The HSWA places the following general duties on the employer, which apply to staff ,students, visitors and contractors:

- **provide safe place of work**
- **provide safe plant and equipment**
- **provide safe systems of work**

9

General duties on employees

The HSWA places the following general duties on staff, students, visitors and contractors:

- **to take reasonable care**
- **to co-operate with the employer**
- **not to interfere with safety arrangements**

10

Reasonably practicable

- Risk should be set against the effort required to remove it.
- It is not reasonably practicable if the cost of removal of risk is disproportionately high
 - It is reasonably practicable if a risk can be removed at minimal cost and effort

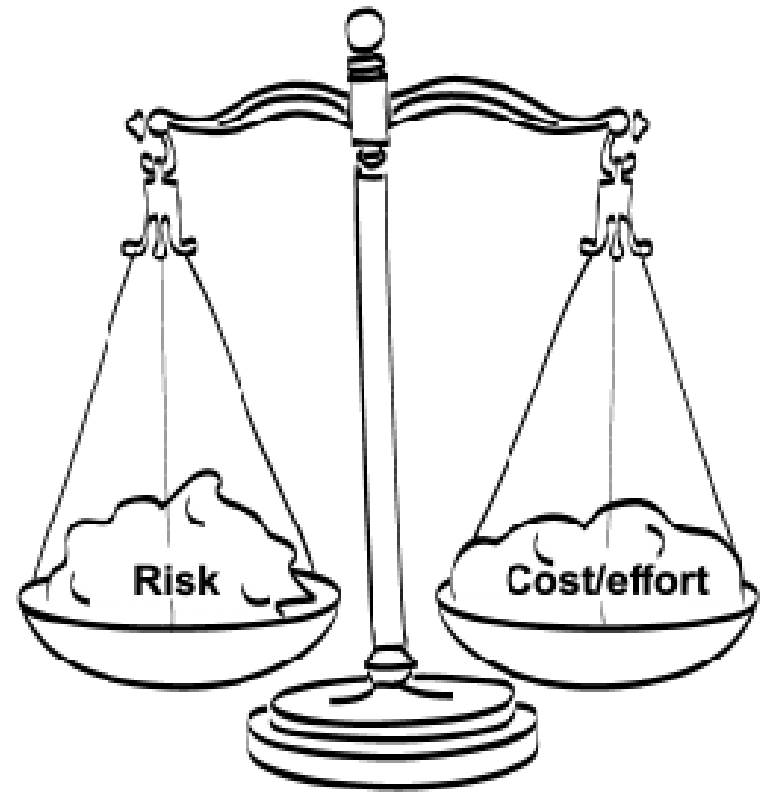

11

Herald of Free Enterprise

“The failure on the part of management to give proper and clear direction was a contributory cause of the disaster.”



Responsible People for Midland Networks

-
- Mark Horrobin – Engineering Director
 - David Donnelly – Operations Director

13

Safety Management

This begins with Policy and uses tools such as Local Rules and Risk Assessment to establish control of the hazards and risks of work.

It is a specific legal duty to manage safety so that all risks are suitably and sufficiently controlled.

14

Safety Policy

- Legal requirement under S2(3) of HSWA.
- Midland Networks published on web
- Schools need their Policies.
- Labs/buildings may need additional policy/arrangements to provide more detail.
- Arrangements will need to include Local Rules.
- Some local rules are needed by law - e.g. rules for Ionising Radiation.

15 Policy

The Midland Networks Safety Policy **MUST** be followed by all staff.

Identifying the main hazards

Examples which affect safety and/or health:

- Biological hazards
- Chemicals
- Fire
- Radiation
- Waste
- Electricity
- Noise and Vibration
- Lifting and carrying
- Repetitive movements

This is the first step in

Risk Assessment

17 Fire

- **All Fire Alarms must be treated as genuine**
- Evacuate immediately
- Close doors and windows as you leave
- Go to the assembly point



Actions to take to prevent Fire

- Keep smoke doors closed
- Do not obstruct escape corridors
- Store fire risk materials correctly
- Control wastes.

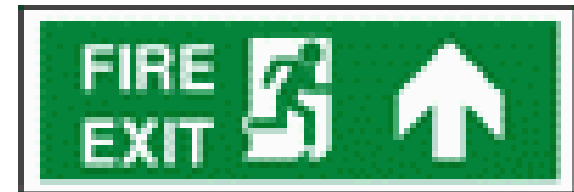

Dutch fire claims eight lives

“I saw disorientated youngsters with fear in their eyes... probably blind panic is the reason so many people have been injured”
eyewitness - Mayor Frank Ijsselmuiden

19

Waste

- Many accidents are caused by incorrect disposal of wastes.
- Wastes must be segregated by law.
- Midland Networks has strict rules.
- Errors put others at risk.



Legal duties

COMMON LAW

- **duty of one individual to another - “Duty of Care”**

STATUTE LAW

- **Criminal Law**
- **duty between individual and the state**

The costs of failure

Health and safety law is Criminal Law

Failure to manage health and safety can result in:

- **prosecution, fines and imprisonment**
- **compensation claims**
- **loss of output or service**
- **replacement costs**
- **loss of reputation**



Any Questions

If you have any questions on general Health and Safety issues please speak to your manager.

If you have questions about this presentation please ask.

If you want to attend any further safety training courses please email
dave@midlandnetworks.co.uk